

Bonfino

Sensi Swing Electric Rocker

Age Group

0+

MONTHS

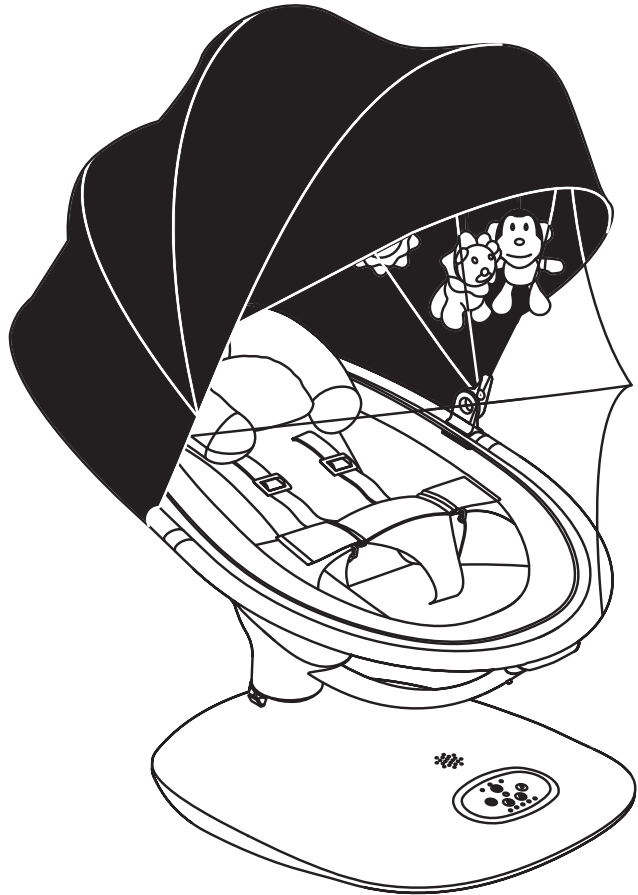
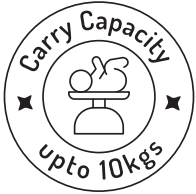

Style Code

BF0BGBRS003

Note – Please take a few minutes to read this manual. This will help you assemble and use the bassinet suitably. Keep this manual for future reference.

Before assembly, please double check all parts as shown are included in the package. To guarantee the service life of the bassinet, please use it correctly as per the instructions and make it thorough inspection regularly. Never use it if any parts are missing or broken.

WARNINGS

IMPORTANT! READ CAREFULLY AND KEEP FOR FUTURE REFERENCE

WARNING! For your child's safety and health.

WARNING! To prevent serious injury or death from infants falling or being strangled in straps:

1. Do not use this product once your child can sit up unaided or weighs more than 9 kg (20 lb). Do not use the swing for routine sleep.
2. This product is not intended for prolonged periods of sleeping.
3. Power adapter cable: Strangulation hazard! Keep the cable out of reach of children.
4. This product contains a Button or Coin Cell Battery. A swallowed Button or Coin Cell battery can cause internal chemical burns in as little as two hours and lead to death.
5. To avoid injury, ensure that children are kept away when unfolding and folding this product.
6. Do not let children play with this product.
7. When the product is connected to a music player, ensure that the volume of the music player is set to a low value.
8. Dispose of used batteries immediately. Keep new and used batteries away from children. If you think batteries might have been swallowed or placed inside any part of the body, seek immediate medical attention.
9. Transformers used with the infant swing are to be regularly examined for damage to the cord, plug, enclosure, and other parts. In the event of such damage, they shall not be used. The infant swing shall only be used with the recommended transformer.
10. Check this product regularly and contact the retailer where you bought it for replacement parts if needed. Never substitute parts. Never leave the child unattended.
11. Stop using the product when the child starts trying to sit up.
12. Never use this product on an elevated surface (e.g., a table).
13. Always use the restraint system.
14. Never use the toy bar to carry the product.

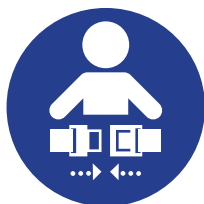

Always secure
infant in the
restraint system
provided.



Never leave
infant unattended
in swing.

ADDITIONAL WARNINGS:

1. Do not move or lift this product with the baby inside it.
2. Never let the child sleep in this product. This product does not replace a cot or a crib. Should the child fall asleep, then it should be placed in a suitable cot or crib.
3. Do not use the product if any components are broken or missing.
4. Do not use accessories or replacement parts other than those approved by the manufacturer.
5. Keep away from fire!
6. Always secure infant in the restraint system provided.
7. Never leave infant unattended in swing.

BATTERY WARNING

In exceptional circumstances, batteries may leak fluids that can cause a chemical burn injury or ruin your product. To avoid battery leakage, follow the instructions below.

1. Insert batteries in the correct polarity position (+ and -).
2. Do not short circuit battery terminals.
3. Remove batteries during long periods of non-use. Always remove exhausted batteries from the product and dispose of them properly.
4. Use caution when opening the battery compartment, as some batteries may leak, explode, or catch on fire.
5. Do not submerge in water or other liquids.
6. Do not dispose of this product in a fire. The batteries inside may explode or leak.
7. Only batteries of the same or equivalent type as recommended are to be used.
8. Do not charge non-rechargeable batteries.
9. Remove rechargeable batteries from the product before charging.
10. If rechargeable batteries are used, they are only to be charged under adult supervision.

WARNING

1. The electrical source terminals shall not be short-circuited.
2. When using adapters, keep them away from children.
3. Transformers used with the product are to be regularly examined for damage to the cord, plug, enclosure and other parts, and in the event of such damage, they shall not be used.
4. The product shall only be used with the recommended transformer.

PARTS

Please check the product list before use, if any missing, please contact the buyer to purchase.
Take out all the parts from the package carton.

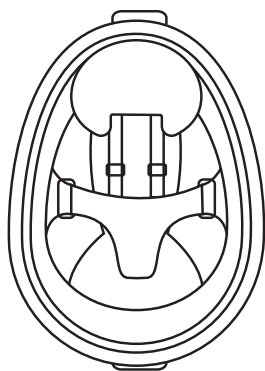

Seat

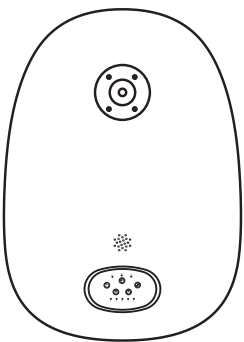

Base

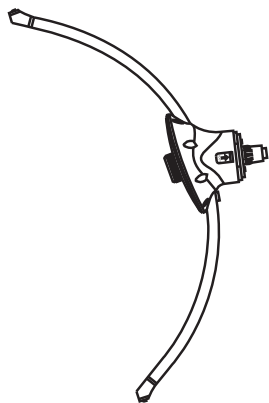

Rotating base + Sliding Tube



Toy Bar

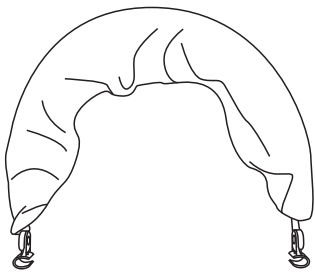

Canopy

PRODUCT STRUCTURE

The picture in this manual may be different from the product, please refer to the actual contents.

1. Sliding tube & Rotating seat base and Seat

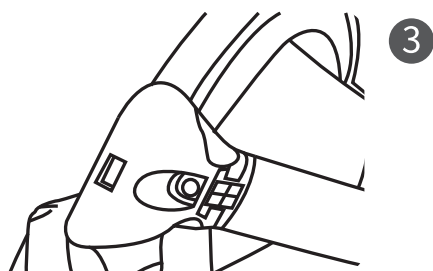
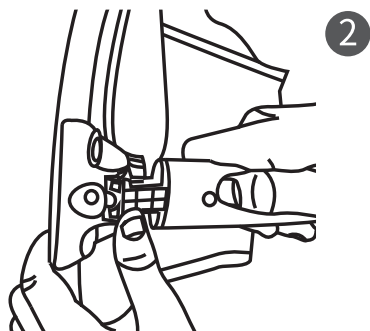
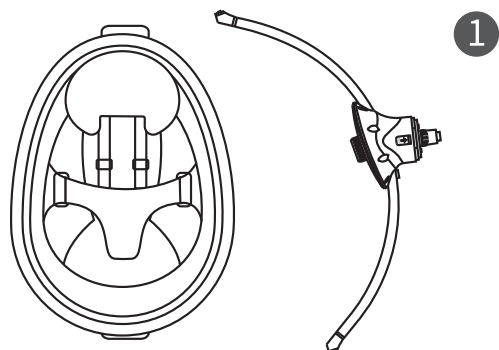

Insert one end of the sliding tube shrapnel into the securing plastic of the seat head, and insert one end of the rivet into the securing plastic of the seat foot.

2. Seat & Sliding tube & Rotating base & Chassis installation

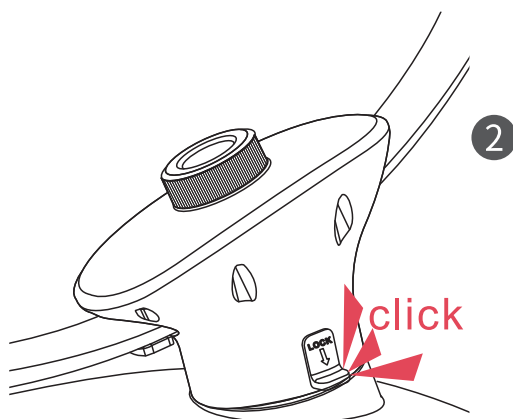
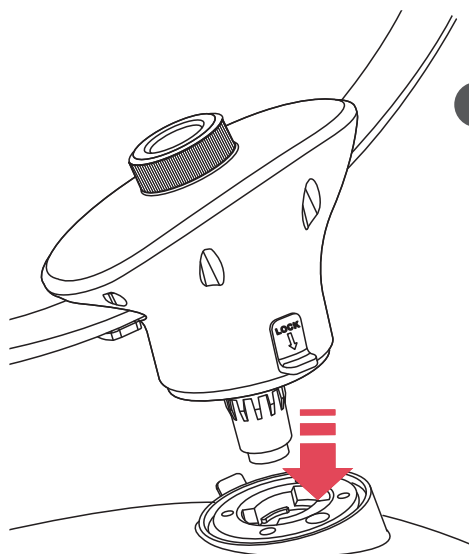

Align the rotating base semicircle with the motor semicircle and insert into the chassis.

3. Toy Bar Installation

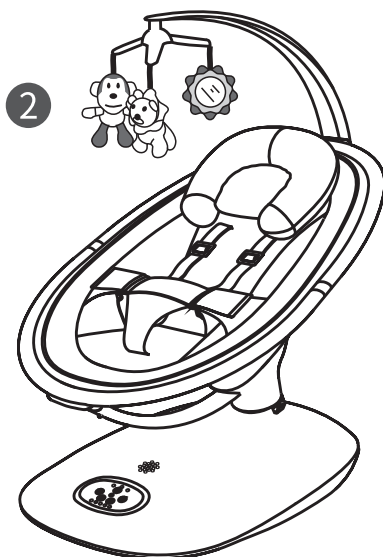

Insert the toy bar into the supported seat frame.

4. Canopy Assembly

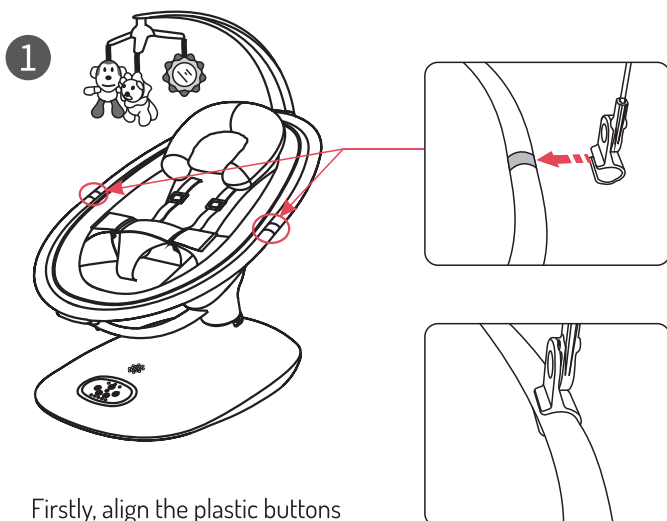

Firstly, align the plastic buttons on both sides of canopy with the baby swing and insert them in the right place, while you will hear a sound in "click".

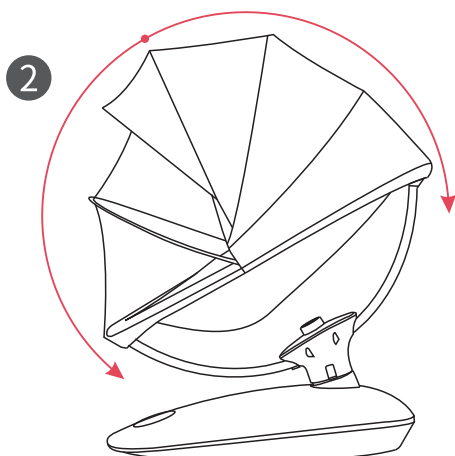

Unfold the canopy forward and backward, and install it on the upper and lower tube of the baby swing and make sure it's installed tightly.

5. How to use Safety belt

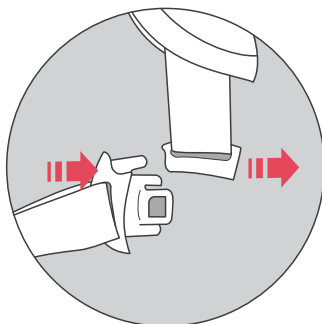

Assembly

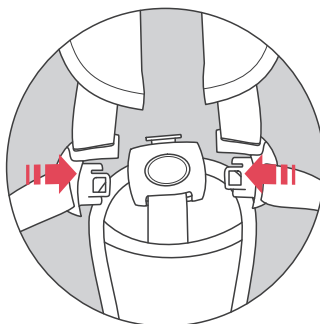

Lock

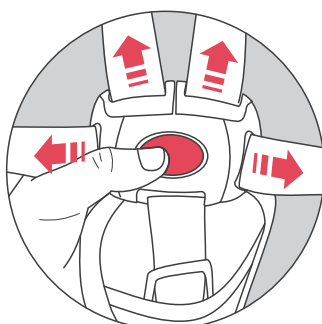

Unfasten

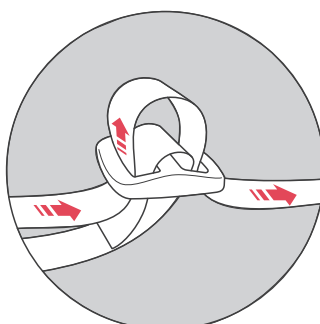

Lengthen / Shorten

Assembly: Insert the waist strap plug into shoulder strap plug.

Lock: Insert the assembled plug on both the left and right sides into the buckle; it locks with a audible "click" sound.

Unfasten: Press the button in the middle of the buckle to release the safety belt.

Lengthen: Stretch the shoulder strap in the direction of the arrow and lock it tightly.

Shorten: Stretch the shoulder strap in the opposite direction of the arrow and lock it tightly.

6. Seat installation & Removal

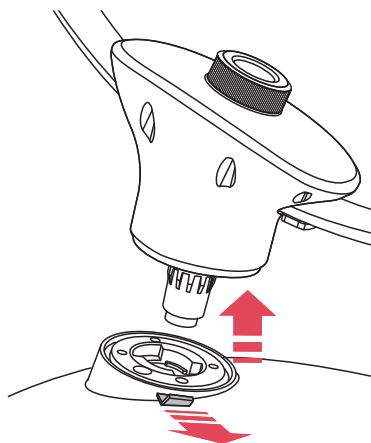

1

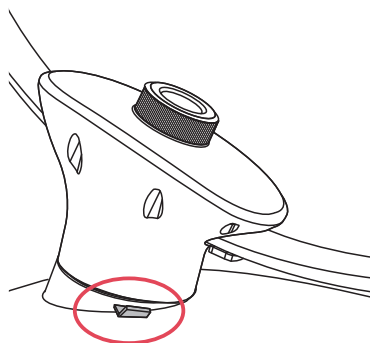

2

With one hand, pull the quick iron plate outward and install the seat with the other hand.

7. Seat Positioned Function

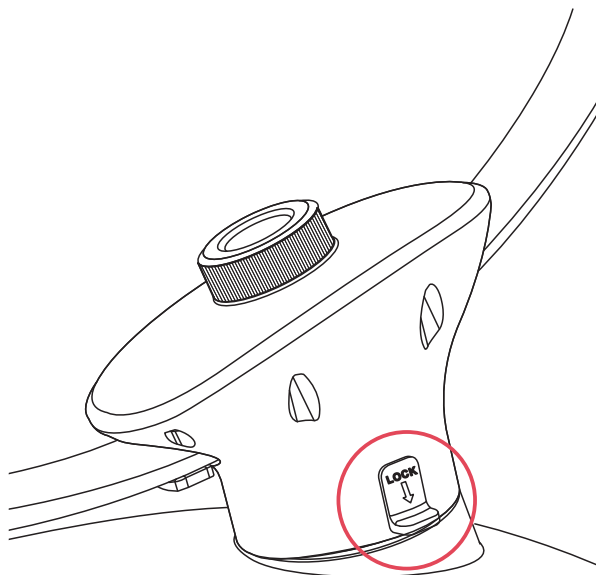

Push downward is to lock, pull upward is to unlock to swing.

8. Seat Recline Angle Adjustment

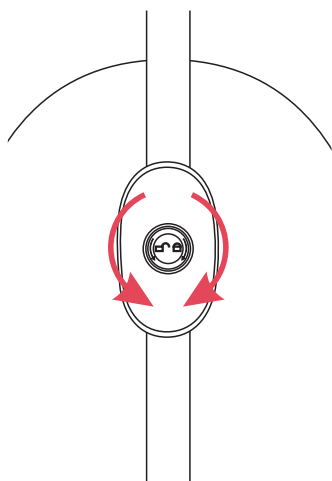

1

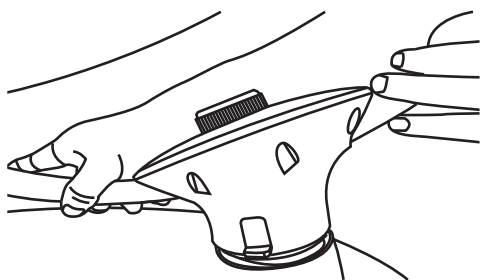

2

Turn the switch to the left to unlock for adjusting gear positions and turn it to the right to lock. It is recommended to hold the unlock switch with one hand and push the sliding tube with the other hand.

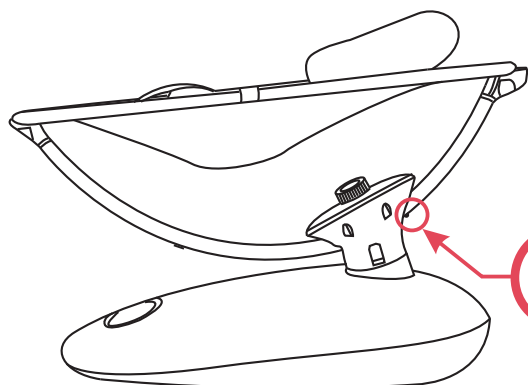

WARNING

To avoid additional harm to the infant caused by the head touching the hard parts under the cloth cover, please do not exceed and press the rear metal shrapnel when using.

9. Power Cord And Battery

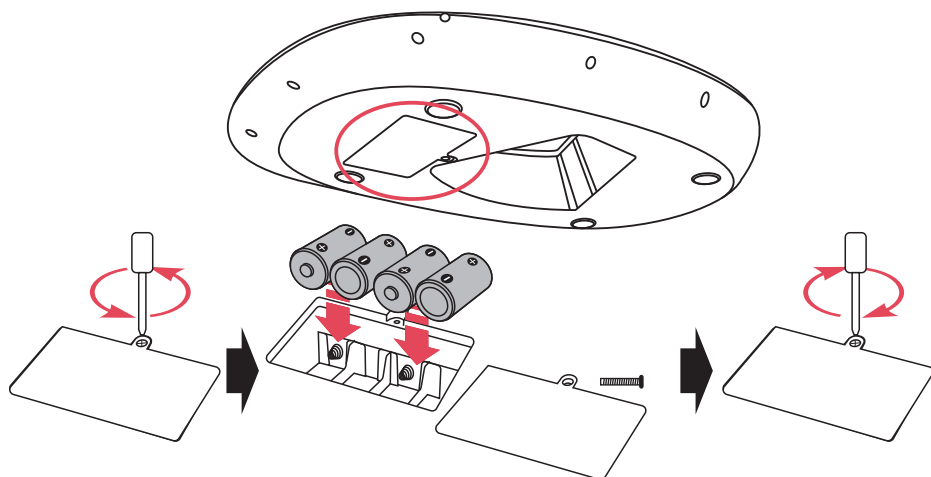

1. Battery Installation: Unscrew the battery cover at the bottom of the Swing Base with a cross screwdriver and remove it. Install 4PCS NO. D batteries in turn according to the positive and negative polarity indicated in the battery compartment, then put back the cover and tighten it with screwdriver again.

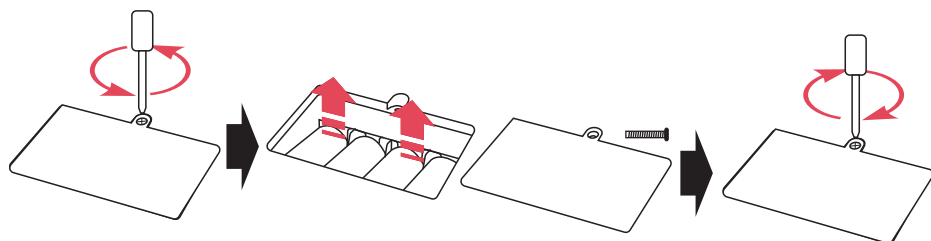

2. Battery Uninstallation: Unscrew the battery cover at the bottom of the Swing Base with a cross screwdriver and remove it. Remove the 4PCS NO. D batteries one by one, then put back the cover and tighten it with screwdriver again.

⚠ CAUTION

To prevent battery leaks, which can burn skin and eyes:

- Always replace the entire set of batteries at one time.
- Never mix old and new batteries, or batteries of different brands or types.
- Remove batteries when storing product for a long time.
- Dispose of used batteries immediately.

B. Power supply mode 2:

Insert the power cord into the power socket on the chassis and plug into the household 220V power supply , it can work normally.

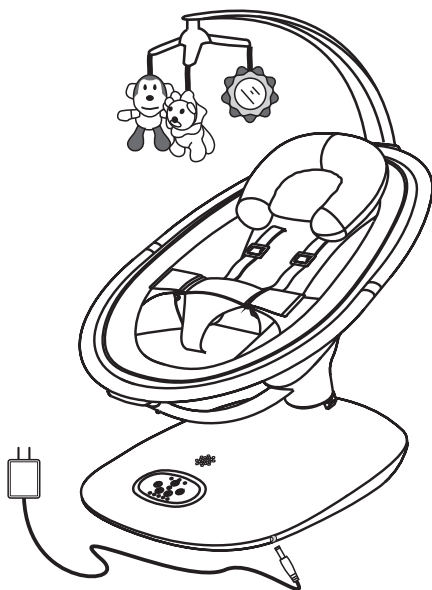

⚠ CAUTION

To prevent battery leaks, which can burn skin and eyes:

- Always replace the entire set of batteries at one time.
- Never mix old and new batteries, or batteries of different brands or types.
- Remove batteries when storing product for a long time.
- Dispose of used batteries immediately.

OPERATING BABY SWING

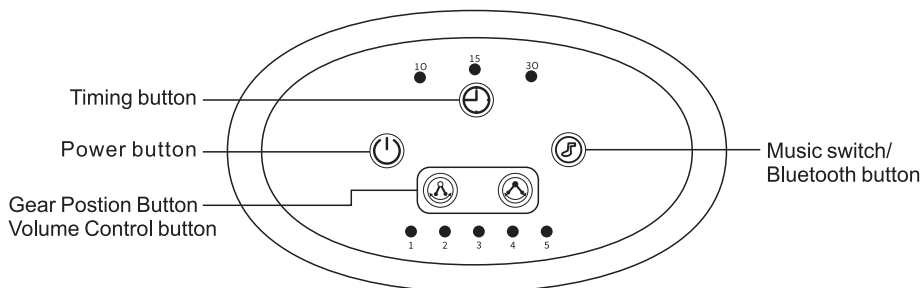

Power button

1. Power on the DC power source and insert the plug into the base and the "2" indicator light will shine and then go out, and the product will enter the standby mode.
2. Press the "switch" button, the "2 gear indicator "is on, and then press the " off "(gear). If the boot is uncertain,the system will turn off after 90 minutes by default.

Gear Postion Button

3. Continuously press the "Swing +/ Volume +" button. The gear indicator light will switch until the "5th gear indicator light" is on.
4. Continuously press the "Swing -/ Volume -" button and the gear indicator light will be switched until all the indicators are off. The O indicator is off, and the swing function is off.

Timing button

5. Press "Timing key" to switch the timing lamp position. Press this key continuously to switch the timing lamp position.
6. If the boot is uncertain,the system will turn off after 90 minutes by default.

Music switch/Bluetooth button

7. Press the "music switch/blue tooth "button to play a song or pause a song.
8. Long press "Music Switch/Bluetooth" button, the music playing will switch to Bluetooth mode, then the phone will search for the bluetooth (AC-46) of the product and pair with it. After pairing, the product can play the music in the phone.At this time, you can press this button to control to play or pause a song.

Volume Control button

9. Long press "Swing +/ Volume +" to increase the volume
10. Long press the "Swing -/ Volume -" button to decrease the volume

SWING BACKREST ANGLE ADJUSTMENT:

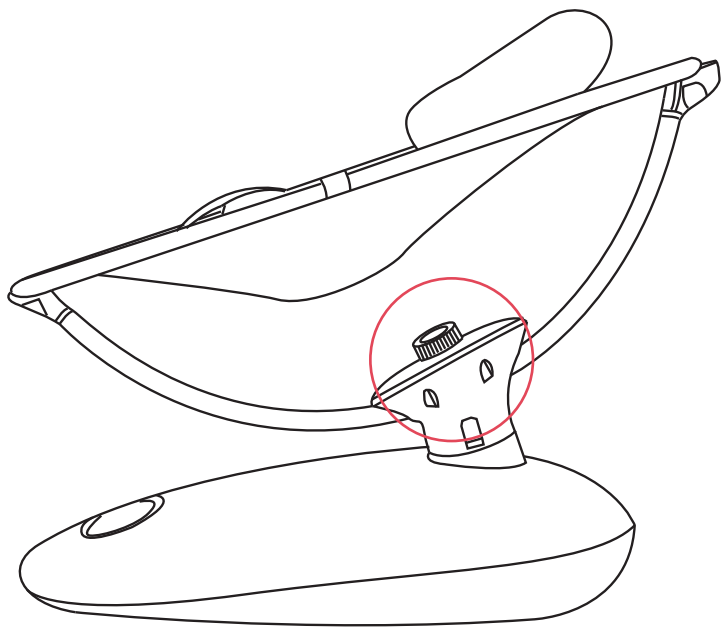

According to the instructions on the base as shown in the picture, rotating the circular ring to unlock/lock and adjust the swing backrest to the right angle and then make it fixed.

SWING BACKREST ANGLE ADJUSTMENT:

Occasionally check your product for loose screws, worn parts, torn material, or stitching. Replace or repair the parts as needed.

- Keep this product in a cool, dry place. If the product gets wet, wipe it with a dry cloth and allow it to air-dry completely.
- Excessive exposure to direct sunlight or heat could cause fading of fabric or warping of parts.
- To clean this product, wipe it clean with a damp cloth using only household soap and cool water. DO NOT BLEACH. DO NOT submerge toys in water.
- The seat pad can be removed from the seat frame and washed by hand in cold water or machine washed on a gentle cycle.



This marking indicates that this product should not be disposed of with other household wastes throughout the EU. To prevent possible harm to the environment or human health from uncontrolled waste disposal, recycle it responsibly to promote the sustainable reuse of material resources. To return your used device, please contact the retailer where the product was purchased. They can take this product for environmentally safe recycling.

Bonfino

Imported & Marketed by:

Digital Age Retail Private Limited

Rajashree Business Park, Plot No. 114, Survey No. 338, Tadiwala Rd., Near Sohrab Hall,
Pune 411001 Maharashtra, India

For Any Feedback, Contact

Customer Care Executive No.: +91-135-3501241 or E-mail: customercare@darp.in

Customer Care Address: Same as Marketer's address

MADE IN CHINA