

0 to 12
Years

Carrying Capacity
Upto 36 kg

User's Manual

Babyhug Bon Voyage ISOFIX Convertible Car Seat

Style Code - B6CS013

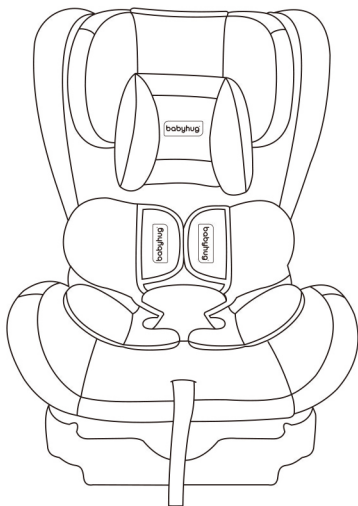

babyhug[®]

baby car seat

- ISOFIX Car Seat
- 5 Point Safety Harness
- 4 Reclining Positions
- Side Impact Protection

Please read the instructions carefully before using the product and keep for future reference.

This is a "Semi-Universal" child restraint. It is approved to Regulation No. 44-04 series of amendments, for general use in vehicles and it will fit most, but not all, car seats. A correct fit is possible if the vehicle manufacturer has declared in the vehicle handbook that the vehicle is capable of accepting a "Semi-Universal" child restraint for this age group. This child restraint has been classified as "Semi-Universal" under more stringent conditions than those which applied to earlier designs which do not carry this notice.

"Only suitable if the approved vehicles are fitted with 3 point/static/with retractor safety-belts."

This combination seat for children from 0-36 kg totally meets or exceeds safety standards and has been certificated to ECE R44. Proper use contributes to the effectiveness of the product. To avoid accidental injuries, please rigorously follow the instruction when you install and use the child safety seat.

Child Safety Seat Placement

Approved to ECE R44	
Groups	Recommended Weight
0+ I II III	0-36kg

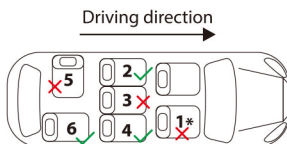

Correct installation/ fit ✓

Incorrect installation/ error ✗

Warning:

Bon Voyage child restraint is only for children from 0 to 36kg.

Only suitable if the approved vehicle is fitted with 3 point/static/with retractor safety-belts, approved to ECE R44 or other equivalent standards.

The vehicle seat faces forward. If your own car belt used to help assemble, Rearward-facing restraint is forbidden to the seats with bags in front.

The safety restraint is secured by seat belts of the car. Never being twisted, all the belts must be adjusted to the child and handled to allow the child to be easily moved into and out of the car.

The safety harness must be worn to fasten the child.

The seat must be fully locked. Should be able to move the child out of the seat in a prompt way under any emergency.

Replacement of child restraints is recommended following a moderate or severe crash in

order to ensure a continued high level of protection for child passengers.

Additional parts or modifications are not recommended, they are highly unlikely to affect

future child safety seat performance.

Keep the seat away from direct sun. The safety seat can become very hot if left in the sun and contact with these parts can burn your child's skin.

Never leave your child alone in the seat and unwatched.

The backrests of the car should be adequately secured and there should be no object on them. (risk of injury)

Never use this safety seat without the cover. The cover is a must for the safety seat.

Child restraint must be used properly and other methods outside the book are not recommended.

Do not use this safety seat at home, and it is only recommended for a vehicle.

Keep the seat away from any corrosive substances.

The user must be informed about how to assemble and install the elastic and rigid parts of the restraint, so as to avoid getting stuck in normal use.

The operation methods of strap and regulation arrangements must be thoroughly understood before using.

The straps connecting to the vehicle must be tightened and the strap for restraining the child should be adjusted to the child without any discomfort caused.

The methods for washing the child restraint system are provided below.

Any modification on the product is highly dangerous.

The luggage and objects which could easily cause damage in a crash should be properly placed.

The instruction of the product must be maintained within its life cycle.

The ISOFIX fixing instruction should be understood before using.

The rigid items and plastic parts of a child restraint shall be so located and installed

that they are not liable, during everyday use of the vehicle, to become trapped by a movable seat or in a door of the vehicle.

In the case of rearward facing systems it is advised not to use them in seating positions where an active frontal airbag installed.

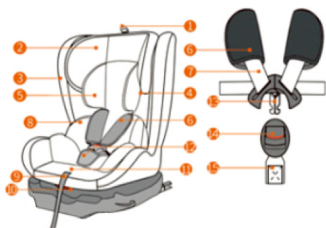

1. Head shake handhandle
2. Headrest
3. Back
4. Seat belt guide hook
5. Five - point seat belt hole
6. Shoulder strap sheathed
7. harness belt
8. Baby cushion for leaning on
9. Adjuster strap
10. At the bottom of the handle
11. Adjustor
12. To protect the hip
13. Card buckle tongue
14. Snap release
15. Snap fasteners connect the webbing

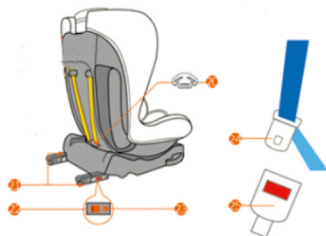

Installation

ISOFIX Installation

As shown in the figure below, flip the front and rear interface of the base.



Adjusting the height of seat and shoulder

Pull the pull ring on the upper end of the headrest (figure 1.5), and adjust the height of the headrest according to the height of the child (figure 1.8).

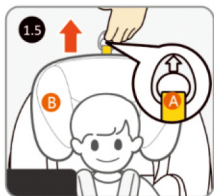

Adjusting the seat Angle

As shown in the figure below (figure 1.10), pull the red handle below the seat base and adjust the seat angle according to your comfort level. The seat is in an upright state (figure 1.11) and the maximum Angle state of the seat (figure 1.12).

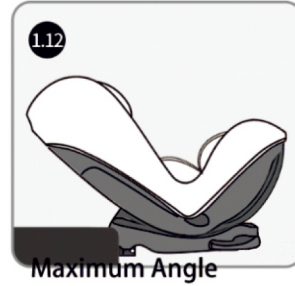

Removing and installing five-point safety belt

Five-point safety belt removal:

Press the lower seat adjuster to release the seat belt to its maximum length (FIG. 2.1), and pull out the seat belt at the rear connection (FIG. 2.2).

Five-point safety belt installation:

Insert the seat belt into the connecting buckle (FIG. 2.8), adjust the shoulder to the appropriate height for children (FIG. 2.7), pull the adjusting belt at the front of the seat (FIG. 2.1), and the five-point seat belt adjustment is completed.

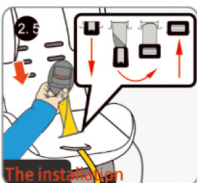
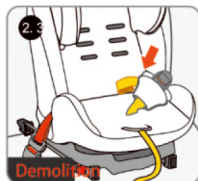
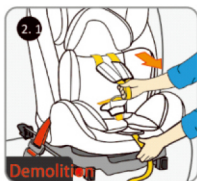

Child Restraint Installation

Group 0+ Rear facing installation (0-13kg, 0 to 18 months old) :

Child safety seat mounting: Car seat belts

Adjust the seat gear position through the first gear, 0+ group seat reverse installation, Do not use in rear facing seats. Use car seat belts alone. and the seat belt is pulled out. The shoulder strap of the car seat belt passes through the blue shoulder strap at the back of the seat and pulls the belly strap under the seat base to secure the seat (FIG. 4.2, 4.3).



Group I Rear facing installation (9-18kg, 9 months to 4 years old) :

Child safety seat mounting: Car seat belts

1 set seat reverse installation, adjustable seat Angle, reverse installation of the seat to use the maximum Angle. tilt (FIG. 4.1), and press the adjustment button under the base to install the seat in reverse. and the seat belt is pulled out. The shoulder strap of the car seat belt passes through the green shoulder strap at the back of the seat and pulls the belly strap under the seat base to secure the seat (FIG. 4.2, 4.3)

Group I Forward facing installation(9-18kg, 9 months to 4 years old) :

Child safety seat mounting: Car seat belts and ISOFIT

ISOFIT should be installed in the first step (the detailed method can be found in ISOFIX Installation).

The vehicle seat faces forward. Press the two red buttons on the ends of the ISOFIT for being longest(FIG. 6.2).

Press the adjustment button under the base, 1 groups of seats are installed forward, the Angle of the seat is not adjustable, the upright Angle of the seat is used when the seat is installed forward. Pull out the car seat belt. The car seat belt passes through the red seat belt guide clip on the back of the seat back. As shown in picture on the right: (FIG. 6.3, 6.4)

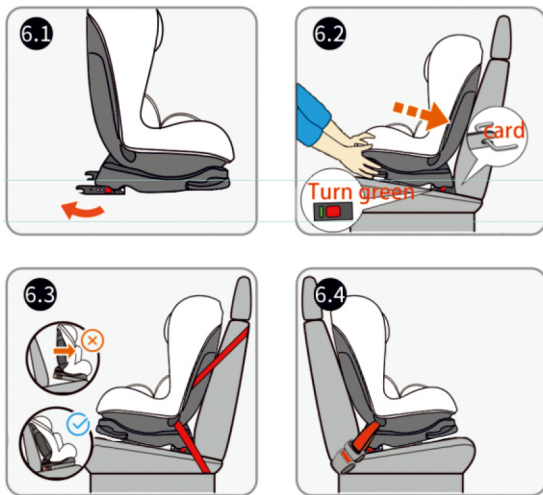

Seat the child in the installed reverse child safety seat and fasten the five-point safety belt.

Group II Forward facing installation (15-25kg, 4 years to 7 years old) and Group III (22-36Kg, 6 years to 12 years old):

Child safety seat mounting method 1: Car seat belts and ISOFIX

Remove the five-point seat belt from the child safety seat. (FIG. 8.2)

ISOFIX should be installed in the first step (the detailed method can be found in ISOFIX installation)

The vehicle seat faces forward. Press the two red buttons on the ends of the ISOFIX for being longest (FIG. 8.4)

Seat forward installation, 2, 3 groups of seats are installed forward, the Angle of the seat is not adjustable, the upright Angle of the seat is used when the seat is installed forward. Put children in car seats. Pull the head of the head pillow to hold hands, adjust to match the height of the child. The diagram below:



Pull out the car seat belt. Let the car seat belt pass the seat belt guide hook of the seat pillow. The car seat belt passes through the red seat belt guide clip on the back of the seat, Let the shoulder strap of the car seat belt pass through the child's chest and the abdominal band pass through the child's abdomen to ensure that the car seat belt does not distort (FIG. 8.5)

Dismantle the safety seat

Dismantle the seat: press the buttons on the ISOFIX and take back the connector. Pick up the child safety seat and loosen the string of the cover. Remove the cover from the seat.

Washing the cover:

Only the original cover offered by the manufacturer is available to make a change. The cover is a part of the restraint system being functional.

The washing instruction in the label of the cover should be noticed. The removed cover should be washed in the temperature 30° C with gentle detergent. Do not centrifugal machine, do not use dissolvent, and do not iron.



Imported & Marketed by

Brainbees Solutions Pvt. Ltd.

Corporate & Registered Office Address:

Rajashree Business Park, Plot No: 114,

Survey No. 338, Tadiwala Road,

Near Sohrab Hall, Pune 411 001

Customer Care No. :

020-46608179

E-mail:

customercare@brainbees.com

Customer Care Address:

Same as above