

Note – Please take a few minutes to read this manual. This will help you assemble and use the bassinet suitably. Keep this manual for future reference.

Before assembly, please double check all parts as shown are included in the package. To guarantee the service life of the bassinet, please use it correctly as per the instructions and make thorough inspection regularly. Never use it if any parts are missing or broken.

For Your Child's Health & Safety

- Before use, remove and dispose of all plastic bags and packaging materials and keep them out of reach of children.
- This product is intended for use for babies aged between 0 and 6 months, weighing up to a maximum of 15 kg.
- When a child is able to sit, kneel or pull themselves up, the crib shall not be used anymore for the child.
- Do not use the product if any part is broken, torn, or missing.
- Be aware of the risk of open fires and other sources of strong heat, such as electric bar fires, gas fires, etc.
- Before assembly, check that the product and all of its components have not been damaged during transportation. Should any part be damaged, do not use it and keep it out of reach of children.
- The product is ready for use only when all locking mechanisms are engaged. Check carefully that these are engaged before use.
- When the child is left unattended in the product, in "crib mode", always make sure that the side rail is raised and the zips are completely closed.
- When the child is left unattended in the product, in "crib mode", the wheels must always be locked.
- All opening, adjusting, anchoring and positioning operations of the product must be carried out exclusively by an adult.

- Before use in "co-sleeping mode" (fixed to bed) make sure the product is properly anchored and positioned.
- When the product is used in "co-sleeping mode" (fixed to bed), before laying the child in it, make sure that the connection belts are hooked and tensioned properly, the product must be secured to the adult mattress and no gaps between the product and the adult mattress must be present.
- The product must always be placed on a horizontal surface. Never leave the product on an inclined surface with the child inside of it.
- Children must not be permitted to play without adult supervision near the product.
- Do not use the product without the frame.
- Keep the fastening belts away from the reach of children.
- Only use the mattress supplied by the manufacturer.
- The thickness of the mattress must be such that the vertical height (upper surface of the mattress until the upper edge of the product's sides) is at least 200mm.
- Do not use more than one mattress in the product.
- The reference mark on the product's interior indicates the maximum thickness of the mattress that shall be used.
- Do not leave any object inside the product that could reduce its depth.
- Do not position the product near walls and obstacles to prevent trapping hazards.
- Do not leave small objects inside the product to prevent choking hazards.
- Use only spare parts approved by the manufacturer. Do not apply accessories to the product, which are not supplied by the manufacturer.
- Do not adjust the product with the child inside.
- Do not move the product with the child inside.
- Do not use the product for more than one child at a time.
- Prolonged exposure to the sun may cause changes in tones to the product's color. After a prolonged exposure of the product to high temperatures, wait a few minutes prior to placing your child in it.

- The product must be kept away from electric cables and cords: do not place the product near windows where cords, curtains, or similar objects could pose choking or strangling hazards for the child. To avoid strangling hazards, do not give to your child or place near her/him, objects equipped with cords.
- All assembly fittings should be tightened properly and care should be taken to ensure no screws are loose, as a child could trap parts of the body or clothing e.g. strings, necklaces, ribbons etc. which could pose a risk of strangulation.
- When not in use, keep the product away from the reach of children.

Co-Sleeping Mode (FIXED TO BED)

- The side support of the crib should always be put close to the adult mattress and the mattress should always be aligned with the height of the side support for restraint of the crib.
- Furthermore, the crib should be firmly fixed to the structure of the adult bed or to the mattress support.
- Check to make sure that the crib in the "co-sleeping mode" does not interfere with the adult bed.
- Use the crib with the tube lowered, only in "co-sleeping mode" (fixed to bed).
- The height of the adult mattress should always be more than that of the side support for the containment of the crib.
- In "co-sleeping mode" the 2 legs of the crib should always be adjusted to the same height.
- Before every use, always check to make sure that there is no space between the adult mattress and the side of the crib. On a regular basis check the condition of the product and the presence of any possible damage. In the case of damage, do not use it and keep it out of reach of children.
- Gaps should not be filled with pillows, blankets or other items.
- Always completely raise the drop side when not attached to the adult's bed.

- To avoid hazards from the child's neck being caught on the top rail on the side that is next to the adult bed, the top rail must not be higher than the adult bed mattress.
- To avoid the risk of strangulation, the attachment system to the adult's bed shall always be kept away from and out of the crib.
- To avoid the risk of strangulation, the attachment system to the adult's bed shall always be kept away from and out of the crib.
- Do not use the bedside sleeper with the following types of adults beds:
 - The adult's bed height is under 46 cm or over 65 cm (from floor to top of adult mattress).
 - The adult's bed width is more than 180 cm

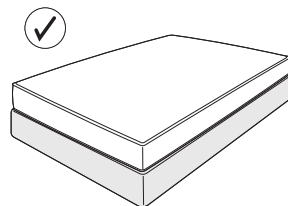

Do not use the bedside sleeper with atypical shaped beds.

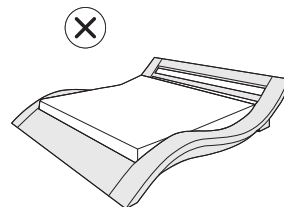
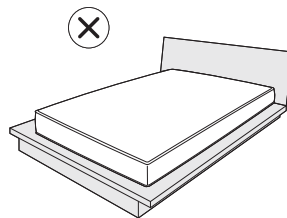

Parts & Accessories

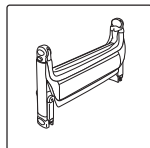

1.Crib x1

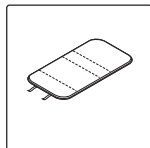

2.Mattress x1

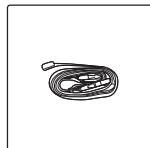

3.Co-sleeper belts x2

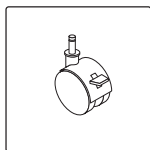

4.Wheels x4

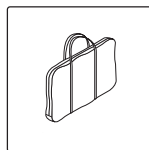

5.Carry bag x1

Assembly Instructions

Step 1

Attach the 4 x wheels (D) to the bottom of the crib (A) feet.

Note. the mattress (B) is wrapped around the crib's body.

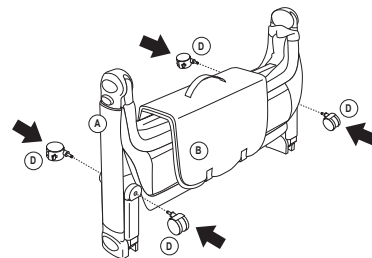

Step 2

Undo the mattress' Velcro tabs and remove the mattress from around the crib's body.

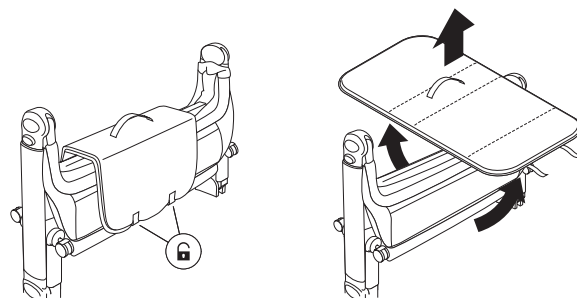

Step 3

- Pull the 4 x feet downwards from the frame. The feet will 'click' to signal locked into position.
- Lift the crib body rails up and outwards to unfold. The rails will 'click' to signal locked into position.

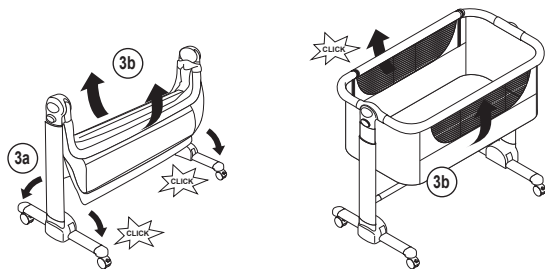

Step 4

Place the mattress (B) into the crib.

Note. Always make sure the drop side is raised and the zips are completely closed in "crib mode".

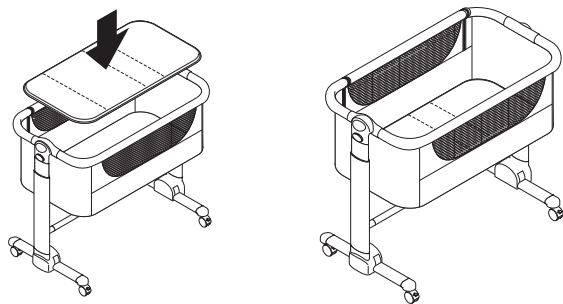

Height Adjustment

Step 1

The crib has 6 height positions. Press the adjustment button on the side and adjust the crib to the desired position.

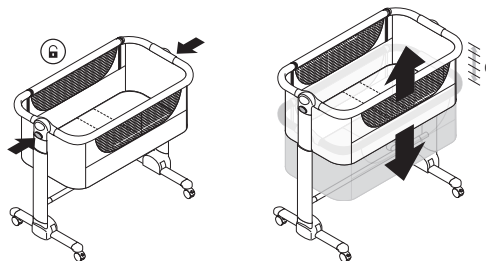

Step 2

The base of the crib can be inclined slightly by adjusting the frame sides to different heights. The crib can be inclined with a max. variance of 2 positions between one side and the other e.g. the right side in position 3 and the left side in position 1.

Note. The head of the child should always be positioned on the highest side.

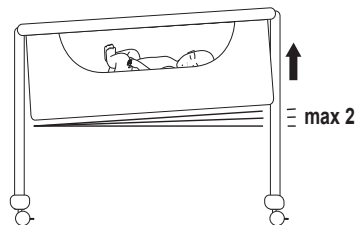

Wheels Assembly

Step 1

Push down the wheel pedals to lock the wheels. Push the pedals up to unlock the wheels.

Note. When the child is left unattended in the product, in "crib mode", the wheels must always be locked.

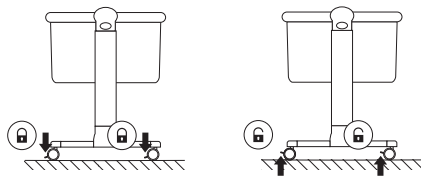

Co-sleeper (Fixed to Bed)

Step 1

Undo the zips to open the drop side. Ensure they are fully open.

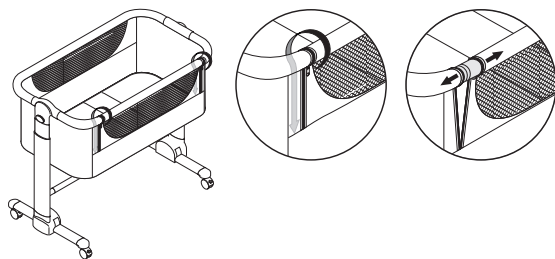

Step 2

a. Push the button and pull the rail out from the tube. Repeat for the other side.

b. Lower the side rail.

Note. If the child is left alone in the crib, always make sure that the drop side is raised.

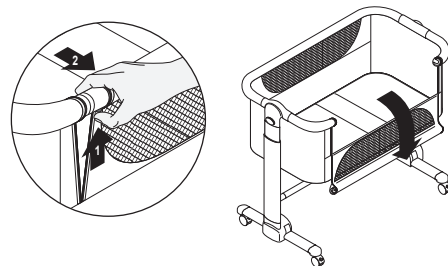

Step 3

Use the "co-sleeper" belts (C) provided to fix the crib to the adult bed. Attach the buckles underneath the crib on both sides.

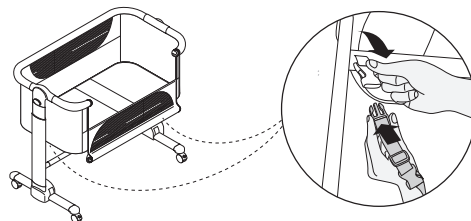

Step 4

- a. Use the "co-sleeper" belts (C) provided to fix the crib to the adult bed.
b. Attach the buckles underneath the crib on both sides.

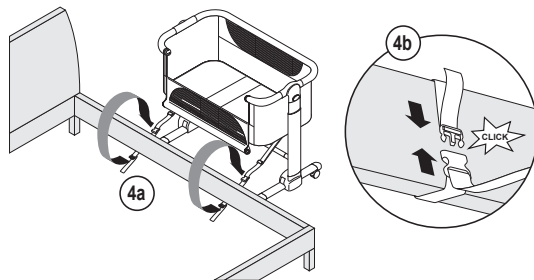

Step 5

Pull on the loose end of the belt to ensure it is secure and tight around the adult bed frame.

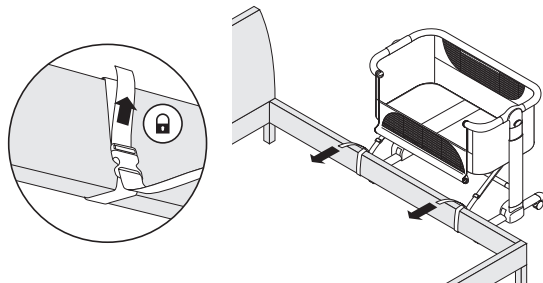

Step 6

Adjust the sliders to shorten and tighten the belts; they must be rigid with no slack. The crib should be right up against the adult bed with no gaps.

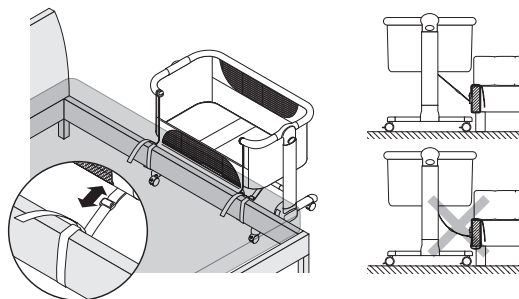

Step 7

Pull on the loose end of the belt to ensure it is secure and tight around the adult bed frame.

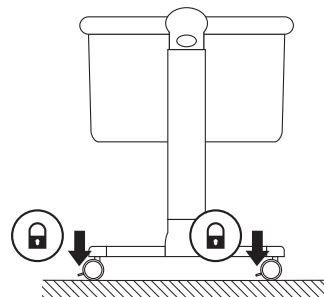

Step 8

Check the height of the crib against the adult mattress and adjust as required.
Note. The height of the adult mattress should always be more than that of the side support for the containment of the crib.

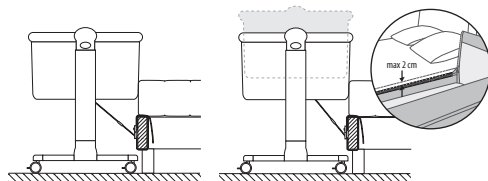

Note.

In "co-sleeping mode" the 2 legs of the crib should always be adjusted to the same height.

Before every use, always check to ensure that there is no space between the adult mattress and the side of the crib.

If there is, pull the belts firmly to tighten them until there's no space and the required condition of use has been restored.

During use, ensure that the adult bed sheets, blankets, etc. do not enter and cover the interior of the crib.

Folding

Step 1

Remove the mattress from the crib.

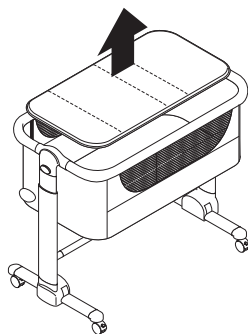

Step 2

Push the button to unlock the rails and push the rails downwards to a close.

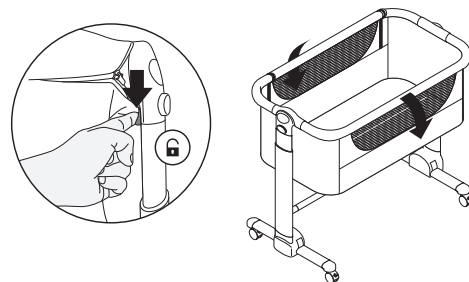

Step 3

Push up the clip to unlock the feet and pull the feet upwards.

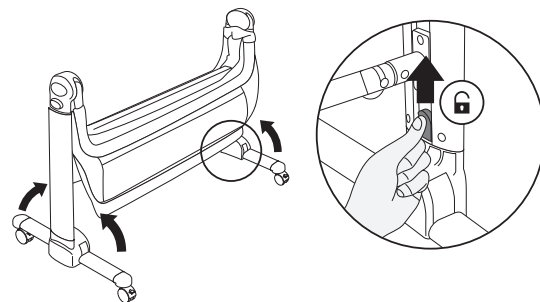

Step 4

Wrap the mattress around the crib body and secure it with Velcro at the base. Ensure the carrying handle is on the outside facing upwards.

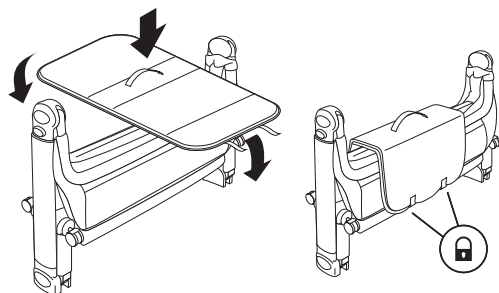

Step 5

The crib can also be carried by the mattress handle. Ensure the mattress Velcro is secure before lifting the crib by the mattress.

A bag (E) is included for easier carrying, transportation, or storage.

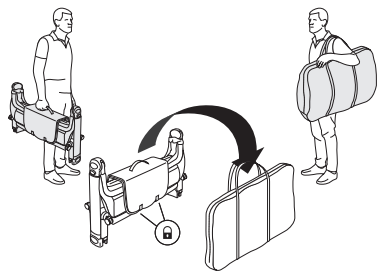

Cleaning Instructions

- Spot-clean the mattress and crib lining using mild soap or upholstery shampoo.
- Never use bleach. Air dry in shade thoroughly before reuse and avoid direct heat and sunlight.
- Do not iron.
- Do not dry clean.
- Check the resistance of the fabric and the stitching after cleaning.
- Wipe the frame using warm water and mild detergent.
- Never use bleach. Never clean any part of the crib with abrasive, ammonia-based, bleach-based, or spirit-type cleaners.
- Ensure the product is fully dry before use or storage.
- Always ensure the crib is stored in a dry place to prevent mold or mildew from developing.
- Store away from any heat sources and not in the sun.