

## 1. Parts & Accessories

---

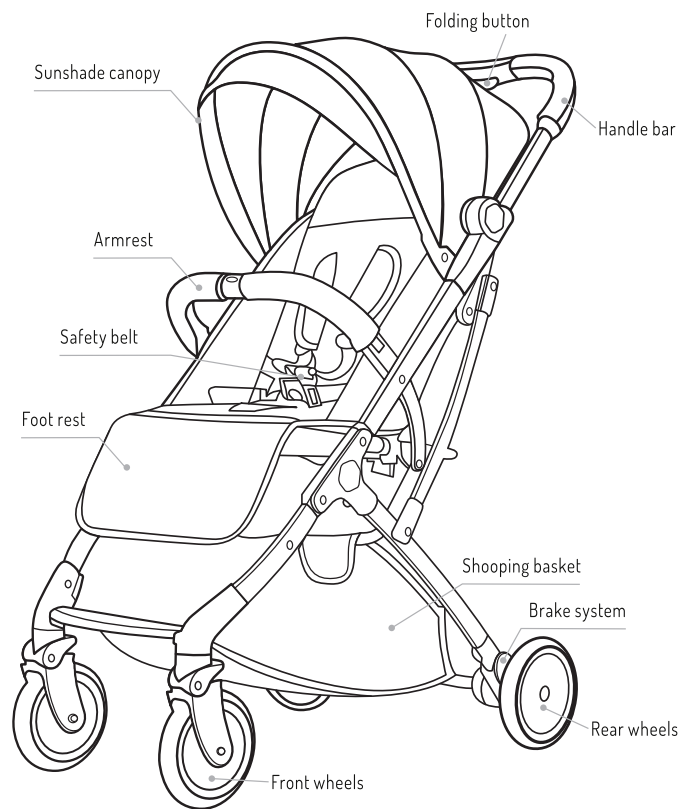

**Note** – Please take a few minutes to read this manual. This will help you assemble and use the stroller suitably. Keep this manual for future reference.

Before assembly, please double check all parts as shown are included in the package. For any missing or defective parts, or sharp edges, please contact customer service immediately. To guarantee the service life of the stroller, please use it correctly under the instructions and make it through inspection regularly. Never use it if any parts are missing or broken.

## Assembly Instructions

### Unfolding the Stroller



Loosen the folding latch and unfold the stroller until it's fully erected and you hear a "click" sound. Open the frame as shown in the picture.

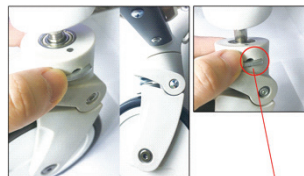

### Front Wheel Assembly

- Put the front wheel sets into the axis.
- To lock the swivel wheels: lift up the positioning part
- To unlock the swivel wheels: press down the positioning part
- Press the button to detach the wheels as shown in the picture

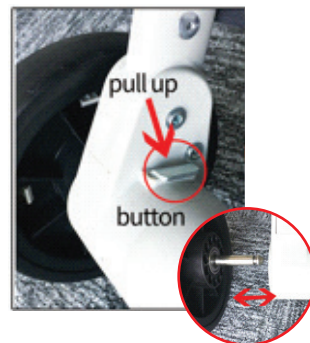

### Rear Wheel Assembly

Push both wheel mounts all the way, until they snap onto the legs. Make sure they are securely fixed.



### Adjust the Footrest

Pull forward to open the canopy, push backwards to close the canopy. To use the canopy extension: Pull the extension out from under the canopy until it snaps into place, push the extension under the main canopy to hide.



### Attaching the Safety Belt

Press the round button in the middle to open the safety belt. Insert the waist belt into the hole and slide the plastic part in or out of the shoulder belt. To adjust the harness or waist belt, loosen the slack on both sides of each buckle.



### Recline Adjustment

Pinch the clamp behind the seat, and slide it down to desired recline. Pull the seat down on both sides to match the clamp position. Reverse steps to return to the upright position.



### Recline Adjustment

Pinch the clamp behind the seat, and slide it down to desired recline. Pull the seat down on both sides to match the clamp position. Reverse steps to return to the upright position.

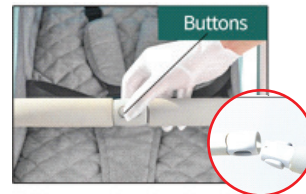

### Using the Armrest

Press the two side buttons at the same time to open. Inject the two parts to lock.

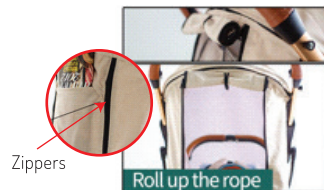

### Using the Window

Open the zippers and roll up the rope to use the window.



### Folding the Stroller

Press the fold button on the handle bar and fold the frame forward. Push the lock release button. Pull up on the folding handle and let the frame collapse. Make sure the storage lock lever clicks into place.



### Using the Trolley Handle

Pull the trolley handle up and down to carry/drag the stroller.



### Using the Window Rope

Insert one rope into another one in order to keep the fabrics safe and clean.



### Storage & Carrying

After folding the stroller, cover it up and store it to protect it from dirt.



### WARNING!

To avoid serious injury from falling or sliding out of the stroller, always use the 5-point safety harness. Snap buckle together.

- Adjust the belt to get a snug fit around the child.
- To Open Buckle
- Press in the middle of the buckle to release.



## For your child's safety

---

- This product is suitable for one child at a time
- This product is suitable for children who cannot sit unaided, roll over and cannot push themselves up on their hands and knees
- Never leave the child unattended in the stroller
- Do not let other children play with the product
- Never use the stroller on stairs or escalators. Be careful while going up or down the slope
- Any load on the push bar and or at the back of the backrest of the stroller will affect the balance
- This stroller is designed for accommodating babies between 0-36 months with a maximum bearing capacity of 15kgs
- Do not place things more than 2kg in the storage basket
- The footrest bearing capacity is 5kgs and the cup holder can bear essentials up to 0.5kgs
- Do not hand purse, shopping bag, parcel or accessories on the handle
- Wheels should be locked before placing and removing the children
- Ensure all the locking devices are correctly engaged before use
- Avoid using a cushion thicker than 20mm when your baby is sleeping in
- Sitting position is not suitable for children below 6 months
- Always use the safety harness
- Not advised to use on very rough terrains
- This stroller is not suitable for running and skating
- Make sure the children are at a safe distance while unfolding and folding the stroller
- Please check the stroller for any loose parts, damaged or broken parts before each use
- Replace at the first signs of damage

## Cleaning and Maintenance

---

### • Cloth Cleaning

1. It is recommended to use a damp cloth for dust and general stains
2. Use mild detergent liquid
3. Seat cover and canopy cover are not machine washable
4. Leave the washed cloth cover in a ventilated place and dry it. Do not expose it to direct sunlight
5. Do not brush the cloth cover hard as it may cause damage to the fabric

### • Frame Cleaning

1. Do not use a corrosive liquid to scrub the frame
2. Use a wet cloth and mild liquid cleaner to wash the frame