







Note – Please take a few minutes to read this manual. This will help you assemble and use the high chair suitably. Keep this manual for future reference.

Before assembly, please double check all parts as shown are included in the package. For any missing or defective parts, or sharp edges, please contact customer service immediately. To guarantee the service life of the high chair, please use it correctly under the instructions and make it through inspection regularly. Never use it if any parts are missing or broken.

Parts & Accessories

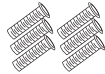
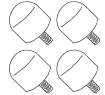
1.Seat With Cover & Safety Belts 	2. 1 Top Legs & 2 Bottom Legs 	3.Double Tray 
4.Footrest 	5.Assembly Screws 	6.Leg Pads (In the Low Chair) 
7.Tray Adjustment /Assembly Button 		

1.Seat With Cover & Safety Belts

2. 1 Top Legs & 2 Bottom Legs

3.Double Tray

4.Footrest

5.Assembly Screws

6.Leg Pads (In the Low Chair)

7.Tray Adjustment/Assembly Button

Assembly Instructions

LEG ASSEMBLY

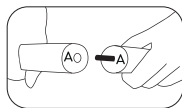

A

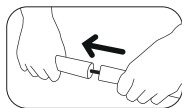

B

Start by forming pairs of top and bottom legs (A-A, B-B, C-C, D-D).

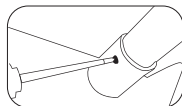

C

Next, screw the top and the bottom leg together, put it inside the opening in the seat and fix using the screw (5).

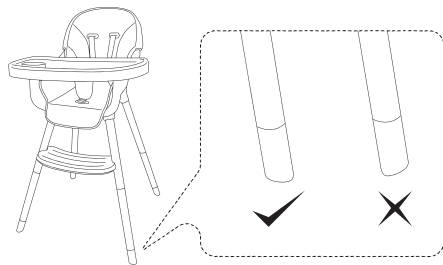

Make sure that the left with the footrest openings are installed in the front and the legs are tightened correctly and the product is stable. Take note of this image presenting the correct leg positioning and placement on the ground.

FOOTREST ASSEMBLY

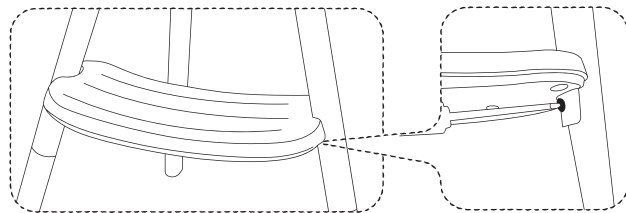

A

Adapt the footrest (4) to the leg openings and tighten using screws (5), as shown in the figure. NOTE!: Do not let the child stand on the footrest and use it as a step!

TRAY ASSEMBLY

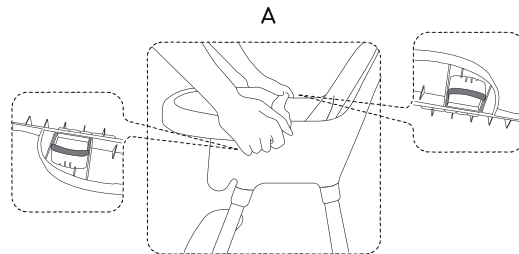

A

Pull the buttons (7) and slide the tray as shown by the arrow shown in the figure until you hear a "click" sound. The tray may be adjusted in one of 3 positions. Once the tray is assembled, make sure it is placed correctly and precisely.

B

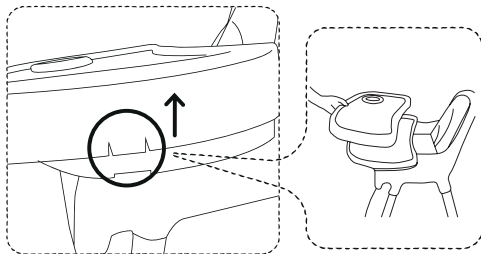

To remove the tray, press the buttons releasing the latching mechanism (7) and pull the tray. The outer layer of the tray may be removed for cleaning, by unlocking the two fixtures, as shown in figure 3B. To reassemble the internal tray, put it above the tray and press the locking buttons until the tray is locked in position.

USING THE SAFETY BELT

A

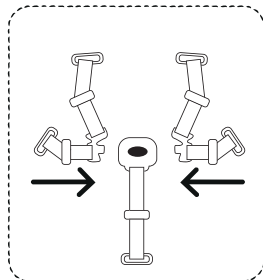

To secure the child in the high chair, check if the locks of the hip belts and the shoulder straps are well connected or connect them, if necessary, then slide them into the buckle of the crotch strap until latched in place.

B

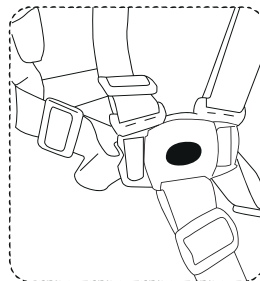

Next, adjust the shoulder strap and the hip belt to the body size of the child (Fig. 4B). Press the central button to release the belt.

Caution! The use of the tray alone does not protect the child against falling out. Belts should be used to ensure the safety of the child. Always buckle the belts when the child is seated in the feeding chair.

Assembling/Removal of Safety Belt

C

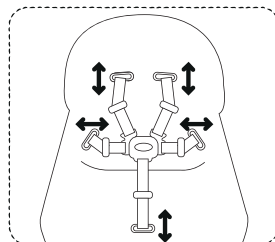

D

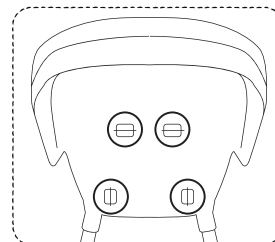

To assemble the belts, perform the same steps in reverse, first sliding the belts through the opening in the cover and then in the seat, such that the ring locks as shown in the image.

Cover Removal:

To remove the upholstery, slide the belts out of the seat and remove the cover.
WARNING! Never use the product without the cover on.

USING THE LOW CHAIR

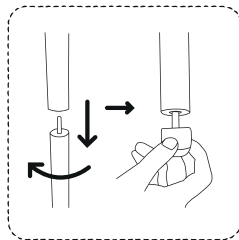
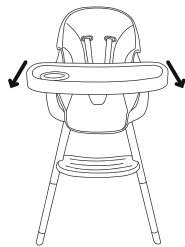

The product may be used as a low chair.

Begin the change by removing the tray and then remove the bottom legs and screw in the pads (6) provided in the kit instead, as shown in the image. Once the pads are tightened, make sure the chair is stable. Do not remove the footrest.

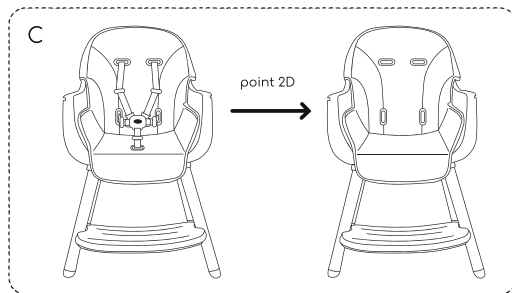

If the child no longer requires the security offered by belts, the belts may be removed following information provided in point 2D. The transformed chair is shown in Figure 5C.



WARNING!

- Adult assembly required.
- Never leave the child unattended.
- Always keep the child in view while in the high chair.
- Always use restraints, and adjust to fit snugly.
- Stay close and watch the child during use.
- Secure your child at all times with the restraint system provided, both in the reclined and upright positions.
- The tray is not designed to hold your child in the chair.
- It is recommended that the high chair be used only by children capable of sitting upright unassisted.
- Always lock the wheels when the child is sitting in the high chair, or when the high chair is open but not in use.
- Ensure placing the high chair on a horizontal, stable surface. Never place the high chair near stairs or steps. Do not move the chair with a child in it.
- The high chair is designed to accommodate one child at a time.
- Discard use if any part is broken, torn, or missing.
- Ensure that all components are correctly fitted and adjusted before and after each use.
- Do not place any heavy bags, packages, or other items on the high chair tray. They may cause the chair to tip over.
- This high chair is recommended for children who can sit upright unassisted OR do not weigh more than 15 kg and are not more than 36 months old.
- Do not place the chair near any heat source, electric bar, fires, gas fires, etc., or where a child could gain access to any other kind of hazard.
- Ensure all users are familiar with the product's operation. It should always open and fold easily. If it does not, do not force the mechanism, instead refer to the assembly instructions.
- All hazards such as electrical flex should be kept out of reach of the child in the high chair.

Wash Care Instructions

Maintenance

- Periodic maintenance is required to ensure the high is in good working order.
- Regularly check all parts of the product to ensure that they are operating correctly and for any signs of wear or damage.

Cleaning

- Never clean any part of the highchair with abrasive, ammonia-based, bleach-based or spirit-type cleansers.
- Ensure the product is completely dry after cleaning before use or storage.
- Make sure the highchair is stored in a dry place to prevent mold or mildew development.
- Frame Cleaning: Wipe with a damp cloth and wipe dry with a soft cloth.
- Harness Cleaning: Sponge clean with a mild soap and water solution. Rinse and wipe dry.