

1. Parts & Accessories

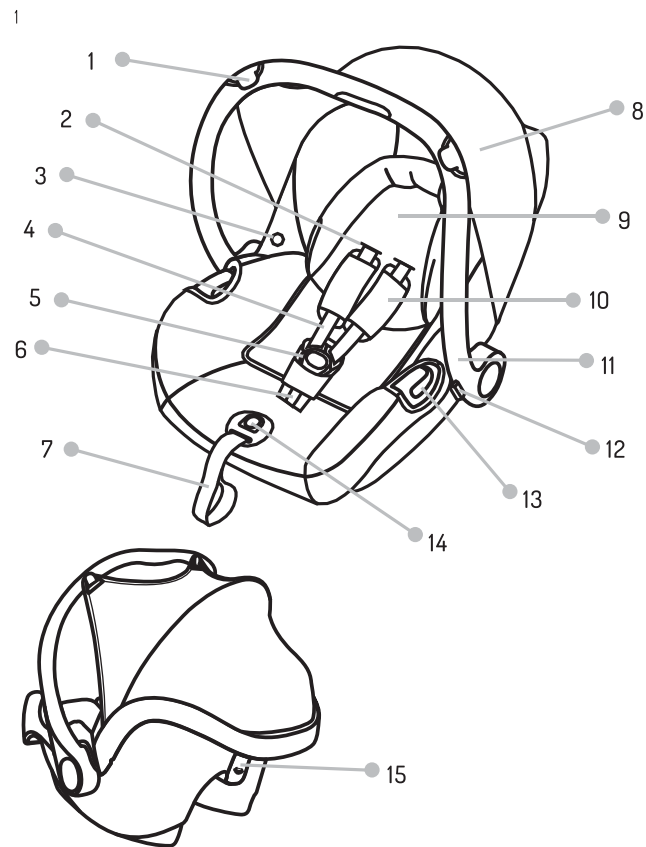

Note – Please take a few minutes to read this manual. This will help you assemble and use the car seat suitably. Keep this manual for future reference.

Before assembly, please double check all parts as shown are included in the package. For any missing or defective parts, or sharp edges, please contact customer service immediately. To guarantee the service life of the car seat, please use it correctly under the instructions and make it through inspection regularly. Never use it if any parts are missing or broken.

- | | |
|---------------------------------|----------------------------------|
| 1. Sun protector hooks | 9. Cushion |
| 2. Harness shoulder strap slots | 10. Shoulder pads |
| 3. Adapter release buttons | 11. Safety seat handle |
| 4. Harness shoulder straps | 12. Handle adjuster |
| 5. Harness buckle | 13. Safety (lap) belt guide |
| 6. Harness crotch strap | 14. Harness adjuster |
| 7. Harness adjustment strap | 15. Safety (shoulder) belt guide |
| 8. Sun protector | |

2. For your child's safety

The seat is designed for children in the age group 0+. This means children from birth to 13 kg body weight.

Group 0+ for children weighing up to 13 kg

It must be placed in the vehicle in the rearward-facing position and secured by a three-point safety harness. Read the instruction manual carefully.

3. General safety

- The car seat must be placed in the vehicle in the rearward-facing position and secured by a three-point safety harness.
- Do not place the child seat in seats fitted with an active frontal airbag, as it may be dangerous. This does not apply to side airbags.
- When placing the seat on the front seat, turn the airbag off. It is recommended to use the seat in the back seats of the car only.
- Suitable for installation only in approved vehicles fitted with three-point safety belts with retractor approved according to UN/ECE Regulation No. 16 or other equivalent standards.
- Note that any straps attaching the child seat to the vehicle must be tight; the restraint harness must fit the child's body and the belt/harness must not be twisted.
- The seat should be replaced if it has been subjected to violent stress in an accident.
- The seat must not be subject to any modifications.
- Keep the car seat away from direct sunlight.
- Never leave your child in the car seat unattended.
- It should be noted that any bags and other items must be sufficiently secured, in particular on the parcel shelf, as otherwise, in the event of a collision, this can lead to injury.
- The seat cannot be used without the cover.
- Do not use replacement covers other than those recommended by the manufacturer, since it is an integral part of the safety seat.

- It is recommended to keep the car seat instruction manual for the entire period of its use.
- Do not use anchorages other than those described in the instruction manual and marked in the child seat.
- All rigid items and plastic parts of the child seat must be located and installed in such a way as to avoid under normal operating conditions of the vehicle being blocked by a sliding seat or vehicle door.
- Regularly check the technical condition of the harness, paying special attention to the fasteners/holders, seams and adjustment elements.
- Discontinue use of the car seat if its parts are damaged or loosened.
- In case of an emergency situation, it is important to quickly unfasten the seat belts. This means that the harness release button is not fully secured; make sure that your child does not play with the buckle.
- Make sure that the belt is properly placed in the guides. The safety belt buckle must be below the belt guide (Fig. 1 M).
- You should give your child a good example and always fasten your belts. An adult with unfastened safety belts may also be a threat to the child.
- Before each trip by car, make sure that the seat is properly secured.
- The car seat must be protected even when not in use. An unattached seat can cause injuries to passengers even during emergency braking.
- Caution! Do not place the seat on platforms such as a table, countertop, bed, etc. due to a risk of falling.



IMPORTANT! KEEP FOR FUTURE REFERENCE

Using the car seat as a reclined cradle (EN 12790:2009)



WARNING!

1. Never leave the child unattended.
2. Do not use the reclined cradle once your child can sit unaided.
3. This reclined cradle is not intended for prolonged periods of sleeping.
4. It is dangerous to use this reclined cradle on an elevated surface, e.g. a table.
5. Always use the restraint system.
6. This product does not replace a cot or a bed. Should your child need to sleep, then it should be placed in a suitable cot or bed.
7. Do not use the product if any parts are damaged or missing.
8. Do not use accessories or replacement parts other than those approved by the manufacturer.

4. Assembly Instructions

2

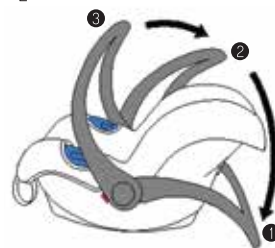

Adjusting handle position (Fig. 2)

Simultaneously push the handle adjuster on both sides (L). Then place the handle in the desired position. Release the button when near the ideal position, adjust the handle slightly until you hear a "click".

Handle positions:

1. Stable position/bouncer
2. Rocker position
3. In car safety position

3



Cushion (Fig. 3)

The seat cushion supports and protects your baby's head and back. The cushion (Fig. 3) behind the head and back can reduce the pressure on the baby's waist (After your baby grows up, the cushion can be removed to provide more space inside the seat).

4

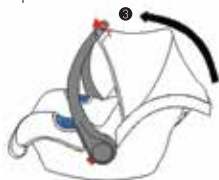

Using the sun protector (Fig. 4)

The sun protector is used to prevent direct sunlight on your child's face. When using the sun protector, first adjust the handle to position 3, then fasten the sun protector to the handle.

When the sun protector is not in use, release the buttons of the handle and fold it back to uncover the inside of the seat.

Adjusting harness strap length

5



Releasing – push and hold the adjuster (N), then lift the shoulder straps (Fig. 5).

6



Tightening – pull the adjustment strap (G) at the front of the seat until the harness lies flat on and fits tightly to the child's body (Fig. 6).

Adjusting the position of harness straps (Fig. 7)

7



When the child grows up, the shoulder straps must be removed from the metal buckle (on the back of the seat) and inserted in a higher slot in the backrest and re-insert in the metal buckle. Make sure that the straps are not twisted. Adjust shoulder strap height so that the strap enters the car seat backrest just below the child's shoulders.

Fastening the child in the seat

2

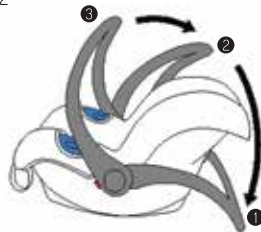

Place the child seat on a flat surface, and then set the handle in a stable position (Fig. 2, position 1).

5

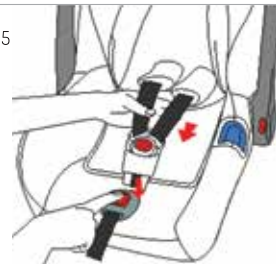

- Loosen the shoulder straps (Fig. 5).
- Press the red button on the harness buckle (E) to release the straps.
- Set aside the two buckle fasteners.

8



Place the child in the seat, then place the shoulder straps on the child's shoulders (Fig. 8).

Note: Do not twist or cross the shoulder straps.

9

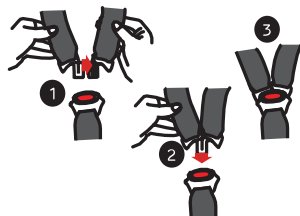

Put together the two buckle fasteners, and then insert them in the buckle (E). A "click" sound can be heard as a sign of locked buckle (Fig. 9).

Note: the proper location of the buckle is near your baby's crotch rather than his/her belly.

10

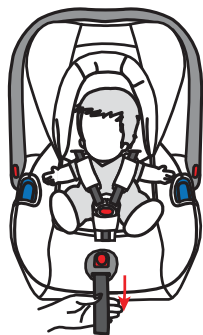

Pull the adjuster strap (G) in the arrow direction to fasten the harness straps (Fig. 10). Ensure that the shoulder straps fit well to the child's shoulders. Proper tension is provided if two fingers fit in the space between the shoulder strap and the child's chest.

Installing in vehicle

2

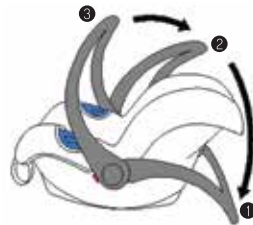

Switch the seat handle to the car safety seat position (Fig. 2, position 3), then place the seat on the back car seat near the backrest.

11



The seat must be placed in the rearward-facing position (Fig. 11).

12



- Pull out the safety belt as much as possible. Place the lap belt over this seat and lock the car belt buckle (Fig. 12).
- Then place the lap belt in the belt guide (M) marked in blue located on the sides of the child seat.

13

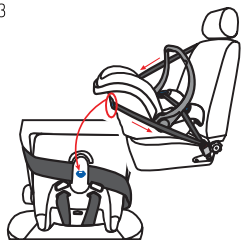

- Pull the shoulder belt over the child seat through the blue belt guide on the back of the child seat (Fig. 13).

Note: Tighten the belt up and make sure that the car safety belt has not twisted or slipped from the guides.

- Push the baby seat to the car seat.

14



Pull the lap belt horizontally to fasten it. Then, pull the shoulder belt to tighten the other parts of the safety belt (Fig. 14).

Note: Make sure the child safety seat is fixed well and stable. Check the belt and make sure it runs correctly.

15

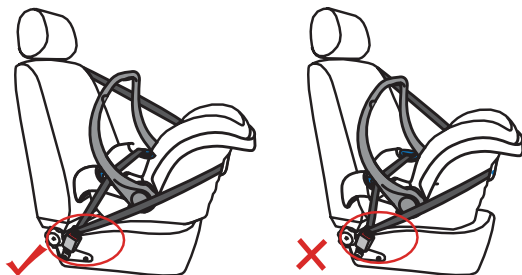

Do not place your baby car seat too close to the car seat belt buckle (Fig. 15).

Installing the seat in stroller frame

- Place the car seat on the stroller so that the child faces the stroller push handle. Before placing the seat in the stroller, always engage the safety brake to prevent uncontrolled movement of the stroller. Place the stroller frame adapters in the holes in the seat and push down until you hear a "click".
- Removing from the stroller: Before removing the seat, engage the safety brake in the stroller.
- Release the lever on the sides of the seat (Fig. 1, part C). The seat is unlocked and can be removed.

The seat has connectors compatible with the Ritzzy Car Seat/Carry Cot standard, so it can be mounted on a number of stroller frames.

Removing the cover and sun protector

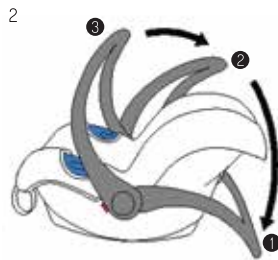

Place the carrying handle in the car safety seat position (Fig. 2, position 3).

16

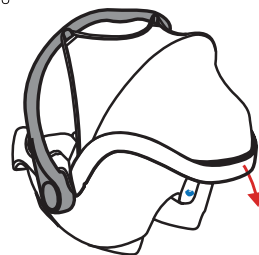

Pull the plastic part aside and move it down slightly, as shown in (Fig. 16).

17

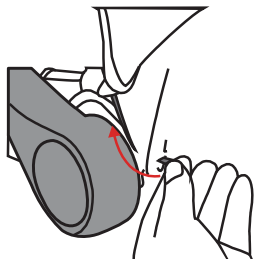

- Release the sun protector hooks in the gap in the direction of the arrow shown in (Fig. 17).

Lift and remove the protector from the seat.

- Press the red button on the harness buckle (E) to release the straps.

18 & 19

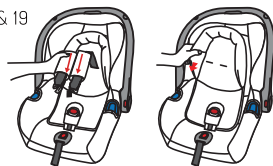

Remove the shoulder pads (Fig. 18) and the cushion (Fig. 19).

2

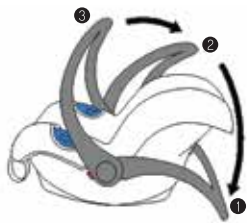

Place the carrying handle in the car safety seat position (Fig. 2, position 3).

20

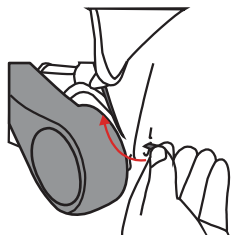

Release the cover hooks in the gap in the direction of the arrow (Fig. 20).

21

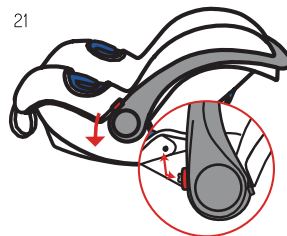

Undo the hook on the edge of the cover downwards in the direction of the arrow. Release the cover hook (Fig. 21).

22

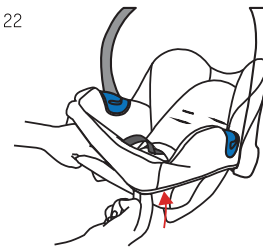

Remove the cover from the edge of the seat on both sides (Fig. 22).

23

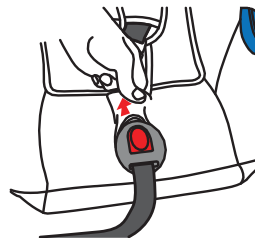

With one hand, hold the front edge of the seat. Put the fingers of the other hand under the cover through the crotch strap opening (F). Pull the cover in the direction of the arrow until you see a small gap between the harness adjuster (N) and the cover (Fig. 23).

25

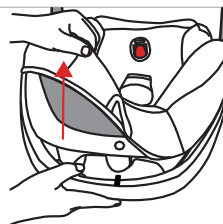

Lift the cover on the side of the headrest in the direction of the arrow shown in (Fig. 25).

26

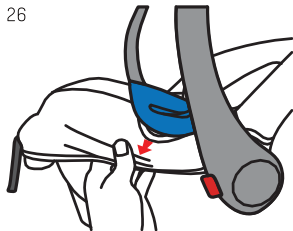

Pull the cover towards the lap belt guides (M) until you see a small gap, and then pull the material from under the guide (Fig. 26). Pull out the crotch strap with the buckle (E, F) through the opening in the cover.

Note: For safety reasons, frequent removal is not recommended.

Installing the cover and sun protector

27



- Put the cover onto the shell. Put the crotch strap with the buckle (E, F) over the opening in the cover.
- Thread the shoulder straps (D) through the holes (B) in the backrest (Fig. 27) and place the strap pads.

28

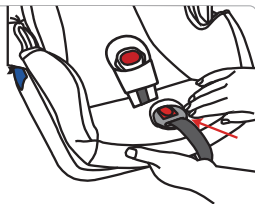

Pull the harness adjuster (N) through the opening in the cover. Then smooth the cover out (Fig. 28).

29

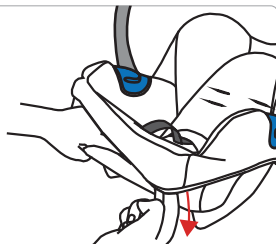

Tighten and secure the cover on the front edge of the seat (Fig. 29).

30

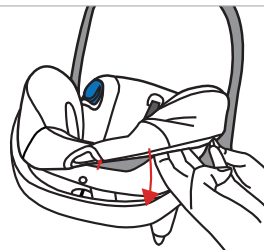

Tighten and secure the cover on the seat headrest (Fig. 30).

31

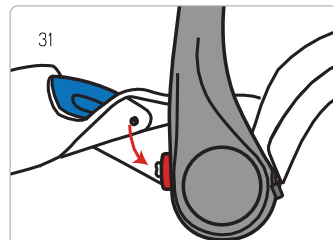

Attach the hooks to the corresponding slots on both sides of the seat (Fig. 31).

2

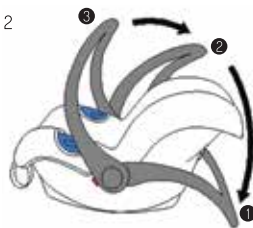

Place the seat carrying handle in the car safety seat position (Fig. 2, position 3).

32

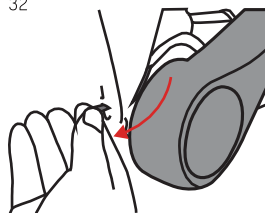

Pull the elastic strap and attach it in the corresponding slots on both sides of the seat (Fig. 32).

33

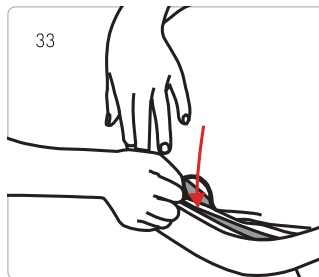

Attach the sun protector to the seat and place it in the space between the seat and the plastic element (Fig. 33). Holes in the protector and cover must match, so that they can be secured with the mandrel in the plastic element. Pull the plastic part aside and put it on the seat.

34

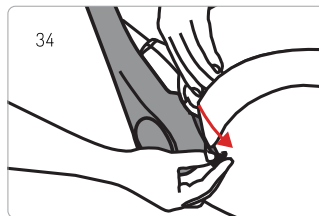

Pull the elastic strap and attach it in the corresponding slots on both sides of the seat (Fig. 34).

Cleaning

Use the original cover only, since it is essential for the safety of the seat. The cover can be removed. Clean the cover in warm water (lower than 30°C) with mild detergent, dry naturally. No drying.

- Plastic parts can be cleaned with soap and water. Do not use abrasive cleaners.
- Straps and tethers can be cleaned in soap water.
- Shoulder pads can be removed and cleaned in soap.